

VHP-1602 Digital Rechargeable Hearing Amplifier

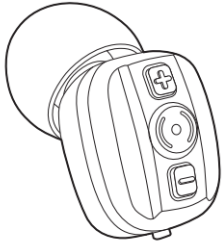

Thank you for choosing VHP-1602 Hearing Amplifier, it will be greatly satisfied to you by its small size and low distortion. If you have any questions, you can ask the local vendors, they will be happy to help you, or directly ask our factory technical service department. Please read the manual carefully before using, under the guidance of a doctor

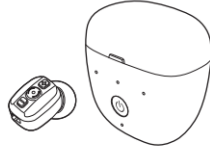

Operation Instructions

Technical Data

MODEL	ITEM	UNIT	PARAMETER INDEX	
			VALUE	TOLERATE
VHP-1602	Size	mm	18.5 x 14.6 x 11.2	
	Weight	g	3	
	Working Voltage	V	DC 1.2V	+5%, -10%
	Working Current	mA	≤ 1.4	
	Frequency Response	Hz	600 - 3800	
	Maximum Saturation Acoustic Output	dB	≤ 128	+ 3dB
	Hi-frequency average value	dB	108	± 4dB
	Full-on Acoustic Gain	dB	28	± 5dB
	Total Harmonic Distortion	%	≤ 7%	+ 3%
Equivalent Input Noise	dB	≤ 29dB	+ 3dB	

Volume Control

Press and hold "+/-" to turn up/down the volume continuously. You will hear tips sound "Beep". When the sound reach the peak or bottom, you will hear tips sound "Beep-Beep".



Operation Steps

1. Choose the best size of dome for your ear, please change the dome as the diagram if needed.

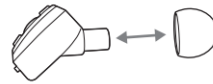

2. Put the switch on "ON" position.

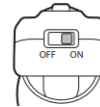

3. Turn the volume to low level before using it.

4. Put the product into the ear as shown on Figure.

- Adjust the volume to a proper level slowly.
- Be sure to switch off after use to save energy.
- Charge it for next use if needed.



Remarks: For Pair Packing, the domes include red color and blue color, you can use them to distinguish for each ear easily.

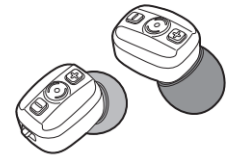

Charging the Amplifier

- Put the switch on "OFF" position before charging.
- At the first time you use it, please make sure the electrostatic membrane is already removed from the charging point.
- Put the Amplifier into the Charging Box, make sure the charging points are in good contact condition.

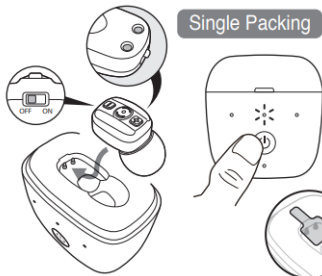

Single Packing

Pair Packing

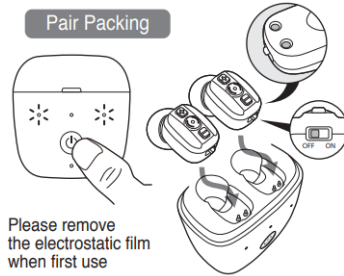

Please remove the electrostatic film when first use

- Turn on the power of the Charging Box. The blue indicator light turns on and flashes continuously when charging, and it will be constant on after the charging is finished. The whole charging process is around 8 hours.
- Turn off the power of the Charging Box and take out the Amplifier after fully charged.

Charging the Charging Box

- Turn off the power of the Charging Box. Insert the micro USB head into the charging port. Please pay attention to the direction of the charging port and the micro USB head, it will damage them if insert in the opposite direction.

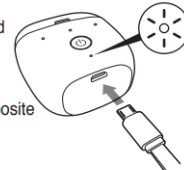

2. Plug the adapter into a power outlet.

INPUT : 100V ~ 240V, AC 50/60Hz, 0.2A
OUTPUT : 5V = 1A

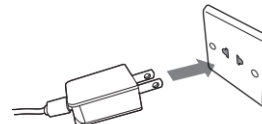

- When charging, the charging indicator turns red, it will turns green when fully charged. The whole charging process is around 3-4 hours. You can charge the Charging Box and Amplifier together.
- Please charging it in time to avoid affecting the battery performance and battery life.
- It's forbidden to let the product connect to 110V-220V-50-60Hz AC outlet directly.
- Please pull the plug when any abnormalities occurred during the charging process. (Such as odor, fever, deformation)
- The built-in battery capacity is greater than or equal to 60% of rated capacity after 500 cycles of charge and discharge.
- Please use the required adapter to charge to prevent safety issue, its parameters is

INPUT : 100V ~ 240V, AC 50/60Hz, 0.2A
OUTPUT : 5V = 1A

as provided in the package.

Attention

- This product is not waterproof, therefore the user must take care to prevent water from entering the product. If water enter the product, remove the battery and place the product in a warm place to dry.
- Use it only when situations require amplification of sounds, such as movies, television and the like. it can't enlarge the extremely sounds.
- Turn product to the OFF position when not use for a long time.
- Do not use in or near an X ray or MRI machine.
- Please charge this product every 3 months even you are not using it, otherwise the product may not working since the battery will not active.

Troubleshooting

Problem	Possible Solution
Sound is distorted	Decrease volume. Charge the product. Clean the dome.
Sound is weak	Charge the product. Increase volume. Replace microphone. Check the dome whether blocked or not.
The product emits whistling sounds	Reinsert the dome until it fits securely. Decrease volume. Clean the dome.
The product does not work	Change to different size of dome. Charge the product. Check whether the microphone is damaged or not.

Consult your Hearing Care Professional or directly contact to us if you encounter further problems.

Warning

It is important to increase the volume control very gradually to avoid sudden increase in sound.

Children can't use this product. If you have any problem, please consult otologists.

The adapter provided in the package is only for charging this amplifier, please do not use it to charge other devices especially cellphones.

Storage

Store in a dry place with good ventilation and related humidity no higher than 80%, and free of corrosive gas.