

VHP-1608 Digital Rechargeable Hearing Amplifier

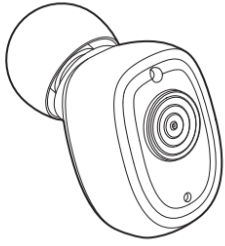

Thank you for choosing VHP-1608 Hearing Amplifier, it will be greatly satisfied to you by its small size and low distortion. If you have any questions, you can ask the local vendors, they will be happy to help you, or directly ask our factory technical service department. Please read the manual carefully before using, under the guidance of a doctor.

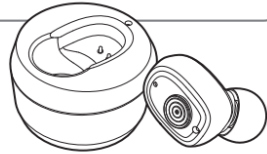

Operation Instructions

Technical Data

MODEL	ITEM	UNIT	PARAMETER INDEX	
			VALUE	TOLERATE
VHP-1608	Size	mm	22.5 x 18.8 x 14.9	
	Weight	g	3	
	Working Voltage	V	DC 3.7V	+5%,-10%
	Working Current	mA	≤ 1.5	
	Frequency Response	Hz	350- 5000	
	Maximum Saturation Acoustic Output	dB	≤ 126	+ 3dB
	Hi-frequency average value	dB	101	± 4dB
	Full-on Acoustic Gain	dB	23	± 5dB
	Total Harmonic Distortion	%	≤ 7%	+ 3%
	Equivalent Input Noise	dB	≤ 29	+ 3dB

Device Safety Level Inner Power Level: B

Main Structure

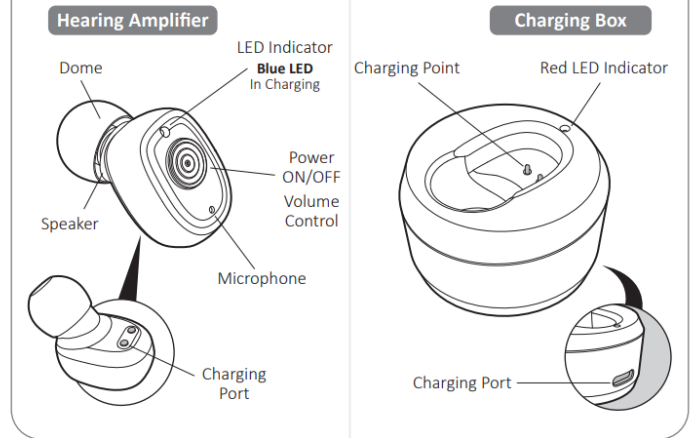

Operation Steps

1. Choose the best size of dome for your ear, please change the dome as the diagram if needed.

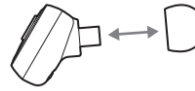

2. Press & hold the Power button for 4 sec. to turn ON the Hearing Amplifier. You will hear tips sound "Beep-Beep" and the RED LED flashes 3 times.



3. Turn the volume to low level before using it.



4. Put the product up-side-down into the ear as shown on Figure.
5. Be sure to switch OFF after use to save energy.

6. To turn OFF the Hearing Amplifier, press & hold the Power button for 3 sec. You will hear tips sound "Beep-Beep-Beep" and the RED LED flashes 4 times.
7. Charge it for next use if needed.

Volume Control

Cycling through 6 Volume Levels:

From the lowest volume level, short press the button to increase the volume level.

Press the Power button to turn up the volume level, you will hear tips sound "Beep". When the sound reaches the peak (Level 6), you will hear tips sound "Beep-Beep".

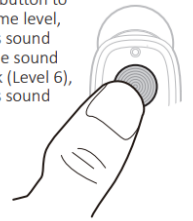

Charging the Hearing Amplifier

1. Plug the supplied power adaptor into a power outlet and connect the charging cable to the Hearing Amplifier Charging Box.
2. The charging indicator of the Charging Box will always turn RED after power up.

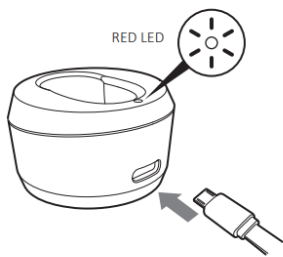

3. Switch "OFF" the Hearing Amplifier and put it into the Charging Box as shown on figure, make sure the charging points are in good contact condition.

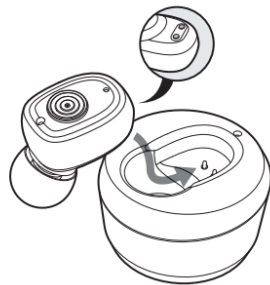

4. The charging indicator of the Hearing Amplifier will turn BLUE when charging. The whole charging process is around 1 hour.

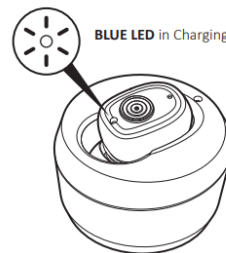

5. The battery life can be up to 20 hours if it is fully charged.

6. Please charge the Hearing Amplifier in time to avoid affecting the battery performance and life.
7. It is forbidden to make the product connect to 110V-220V~50-60Hz AC outlet directly.
8. Please pull the plug when any abnormalities occurred during charging process. (Such as odor, fever, deformation)
9. The built-in battery capacity is greater than or equal to 60% of rated capacity after 300 cycles of charge and discharge.
10. Please use the required adaptor to charge to prevent safety issue. Its parameters is

INPUT: 100V~240V, AC 50/60Hz, 0.2-0.25A
OUTPUT: 5V 1A

Attention

1. This product is not waterproof, therefore the user must take care to prevent water from entering the product. If water enter the product, place the product in a warm place to dry.
2. Use it only when situations require amplification of sounds, such as movies, television and the like. it can't enlarge the extremely sounds.
3. Turn product to the OFF position when not use for a long time.
4. Do not use in or near an X ray or MRI machine.

Troubleshooting

Problem	Possible Solution
Sound is distorted	Decrease volume. Charge the product. Clean the dome.
Sound is weak	Charge the product. Increase volume. Replace microphone. Check the dome whether blocked or not.
The product emits whistling sounds	Reinsert the dome until it fits securely. Decrease volume. Clean the dome.
The product does not work	Change to different size of dome. Charge the product. Check whether the microphone is damaged or not.

Consult your Hearing Care Professional or directly contact to us if you encounter further problems.

Warning

It is important to increase the volume control very gradually to avoid sudden increase in sound.

Children can't use this product. If you have any problem, please consult otologists.

Storage

Store in a dry place with good ventilation and related humidity no higher than 80%, and free of corrosive gas.

All pictures are for reference only