

# VHP-203 / VHP1206 Rechargeable Hearing Aid

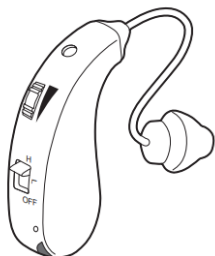

## Operation Instructions

- 1 -

Thank you for choosing VHP-203 / VHP-1206 hearing aid, it will be greatly satisfied to you by its small size and low distortion. If you have any questions, you can ask the local vendors, they will be happy to help you, or directly ask our factory technical service department. Please read the manual carefully before using, under the guidance of a doctor

- 2 -

## Main Structure

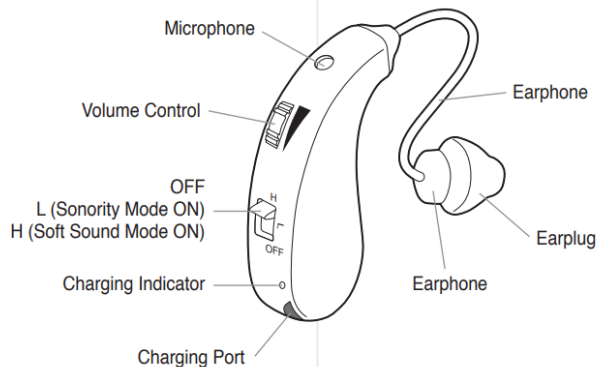

- 3 -

- 4 -

## Technical Data

MODEL	ITEM	UNIT	PARAMETER INDEX	
			VALUE	TOLERATE
VHP-203 VHP-1206	Size	mm	16.6 x 11.4 x 41.7	
	Weight	g	6	
	Working Voltage	V	DC 3.7V	+5% ; -10%
	Working Current	mA	≤ 1.5	
	Frequency Response	Hz	500 - 3100	
	Maximum Saturation Acoustic Output	dB	≤ 128	+ 3dB
	Full-on Acoustic Gain	dB	40	± 5dB
	Total Harmonic Distortion	%	≤ 7	+3%
	Equivalent Input Noise	dB	≤ 29	+3dB

Device Safety Level Inner Power Level: B

- 5 -

- 6 -

## On/Off Switch

"OFF" position: to turn off the product.  
 "L" position: to turn on the product to sonority mode.  
 "H" position: to turn on the product to soft sound mode.  
 Be sure to set the switch to the OFF position when it is not in use to save energy.

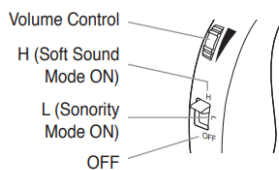

- 7 -

## Operation Steps

1. Turn the volume to the lowest level before use.
2. Turn the power switch to "ON" position before putting it into your ear as follows.
3. Regulate the volume to a proper level slowly.
4. Choose "L" or "H" mode to meet your needs.
5. Be sure to switch off after use to save power.
6. Charge it for next use.

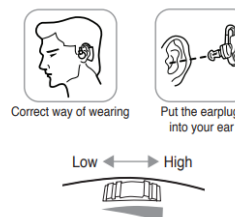

- 8 -

## Charging Instruction

1. Turn the power switch to the "OFF" position before charging. Insert the micro USB head into the charging port. Please pay attention to the direction of the charging port and the micro USB head, it will damage them if insert in the opposite direction.

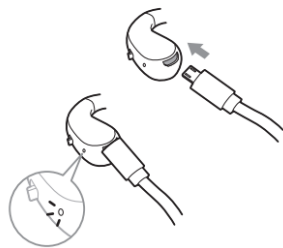

- 9 -

2. Plug the adapter

INPUT: 100V~240V, AC 50/60Hz, 0.2A-0.25A  
 OUTPUT: 5V ---1A

3. When charging, the blue indicator light turns on, and it will be constant on after the charging is finished. The whole charging process is around 2 hours. The indicator light will turn green when it is fully charged. Please don't use the product when charging.

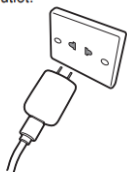

- 10 -

4. Please charging it in time to avoid affecting the battery performance and battery life.
5. It's forbidden to let the product connect to AC outlet directly.
6. Please pull the plug when any abnormalities occurred during the charging process. (such as odor, fever, deformation)
7. The built-in battery capacity is greater than or equal to 60% of rated capacity after 300 cycles of charge and discharge.
8. Please use the required adapter to charge to prevent safety issue, its parameters is

INPUT: 100V~240V, AC 50/60Hz, 0.2A-0.25A  
 OUTPUT: 5V ---1A

- 11 -

## Attention

1. This product is not waterproof, therefore the user must take care to prevent water from entering the product. If water enter the product, remove the battery and place the product in a warm place to dry.
2. Use it only when situations require amplification of sounds, such as movies, television and the like. it can't enlarge the extremely sounds.
3. Turn product to the OFF position when not use for a long time.
4. Please charge this product every 6 months even you are not using it, otherwise the product may not working since the battery will not active.

- 12 -

## Warning

It is important to increase the volume control very gradually to avoid sudden increase in sound.

Children can't use this product. If you have any problem, please consult otologists.

The adapter provided in the package is only for charging this amplifier, please do not use it to charge other devices especially cellphones.

## Storage

Store in a dry place with good ventilation and related humidity no higher than 80%, and free of corrosive gas.

- 13 -

## Troubleshooting

Problem	Possible Solution
Sound is distorted	Decrease volume. Charge the product. Clean earplug.
Sound is weak	Charge the product. Increase volume. Replace microphone. Check earplug whether blocked or not.
The product emits whistling sounds	Reinsert the earplug until it fits securely. Decrease volume. Clean earplug.
The product does not work	Change to different size earplug. Charge the product. Check whether the microphone is damaged or not.

Consult your Hearing Care Professional or directly contact to us if you encounter further problems.

- 14 -

## Label



- OFF — Turn off,  
 L — Sonority Mode ON  
 H — Soft Sound Mode ON  
 — Volume control

All photos are for reference only

- 15 -

- 16 -