



## Operation Instructions

2

### 【Direction】

#### 1. On/Off Switch

“OFF” position: to turn off the machine.

“L” position: to turn on the machine to low tone.

“H” position: to turn on the machine to high tone.

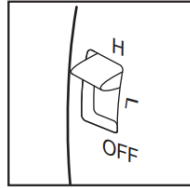

Be sure to set the switch to the OFF position when it is not in use to save energy.

2

【Model NO.】 HAP-20F/VHP-203

【Structure】 Consist of main unit and earplug as follows

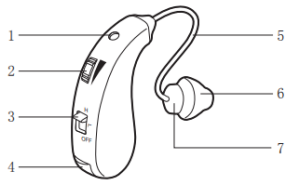

1. Microphone
2. Volume Control
3. OFF - Low Tone (ON) - High Tone (ON)
4. Battery Compartment
5. Ear Hook
6. Ear Plug (L/M/S)
7. Earphone

1

#### 2. Volume control



- ① Turn the volume regulator counterclockwise to lower the volume
- ② Turn the volume regulator clockwise to raise the volume
- ③ Minimize the volume each time before use. Put on the machine properly and choose the desired volume then, because the excessive high volume may make you uncomfortable or damage your hearing ability.

3

#### 3. Loading of battery

1) Insert the battery into the battery compartment, with negative end of the battery in the same direction with “—” in the battery compartment.

2) To take out the battery, open the battery compartment completely, push the battery out slightly with a tool from the negative end. Hard push shall be avoided, otherwise, it may damage the compartment door.

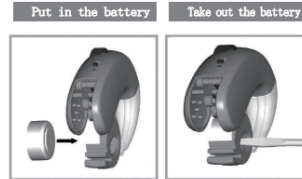

4

#### 4. The battery of the machine

This product is designed based on 1.5V battery, which is available on many electrical appliance shops and department stores.

Battery of the following model is applicable to the product:

**AG13/LR44/L1154**

If you have no idea about the above mentioned battery, please consult the shop assistant.

#### 5. Operation steps

- a) Turn the volume to level 1 before use.
- b) Please check if the switch is on “ON” position before putting it into your ear as follows.



5

- c) Regulate the volume to a proper level slowly.
- d) Choose high tone or low tone to get better listening effect.
- e) Be sure to switch off after use to save energy.

### 【Attention】

1. This product is not waterproof, therefore the user must take care to prevent water from entering the machine. If water enter the machine, remove the battery and place the machine in a warm place to dry.
2. Use it only when situations require amplification of sounds, such as movies, television and the like. it can't enlarge the extremely sounds.
3. Turn machine to the OFF position when not use for a long time.

6

### 【Warning】

It is important to increase the volume control very gradually to avoid sudden increase in sound. Children can't use this product. If you have any problem, please consult otologists.

### 【Storage】

Store in a dry place with good ventilation and related humidity no higher than 80%, and free of corrosive gas.

### 【Label and markings】

“OFF” — Turn off,  
 “L” — Low tone (ON),  
 “H” — High tone (ON),  
 “+” — Positive polarity of battery,  
 “-” — Negative polarity of battery,  
 “▲” — Volume control

【All photos are for reference only】

7