

# Digital Hearing Amplifier

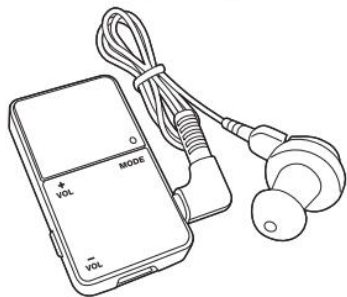

## Operation Instructions

This product is a hearing amplifier, which can catch faint voice from the outside world and get a higher voice within 10 meters. The key of Volume Control and Mode is regulated by CPU digit. Volume Control of 32 magnitudes can offer the volume you want in a more accurate way.

**Model:VHP-801**

### Main Structure:

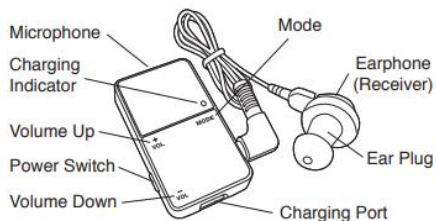

- 2 -

## Direction

### 1. Switch

Slide the switch to "ON" as the figure shows. In turning off state, slide the switch to "OFF" to guarantee a longer life of battery.

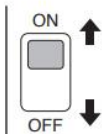

### 2. Volume Control and Mode

- 1) Press and hold "VOL+" to turn up the volume continuously.
- 2) Press and hold "VOL-" to turn down the volume continuously.

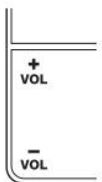

- 3 -

- 3) Mode Switch (High Pitch/Bass Switch), in turning on state, it is low-frequency sound in normal environment. Press the "MODE" key to switch to high pitch, and press again to switch to bass.

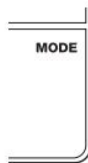

- 4) Adjust the volume to the lowest before use. After the right wearing, adjust the volume to a proper magnitude, or your audition will be weakened.

### 3. Procedures

- 1) Slide the switch to "ON" to turn the amplifier on.
- 2) Adjust the volume to the lowest before wearing.
- 3) Put the earplug into ear holes.
- 4) Adjust the volume to your favorite magnitude.
- 5) After use push the Switch to "OFF" to save battery power.

- 4 -

## Charging Instruction

- 1) Turn the power switch to the "OFF" position before charging. Insert the micro USB head into the charging port. Please pay attention to the direction of the charging port and the micro USB head, it will damage them if insert in the opposite direction.

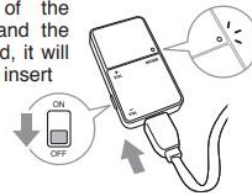

- 2) Plug the adapter into a power outlet.

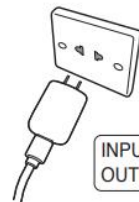

INPUT : 100V ~ 240V, AC 50/60Hz, 0.2A  
OUTPUT : 5V = 1A

- 5 -

## Attention

- 1) This product is not waterproof, therefore the user must take care to prevent water from entering the sound amplifier. If water enters the sound amplifier, remove the battery and place the sound amplifier in a warm place to dry.
- 2) Use it only when situations require amplification of sounds, such as movies, television and the like. It can't enlarge the extremely sounds.
- 3) Turn the amplifier to "OFF" if you don't use it. If you don't use it for a long time, please use the plastic stopper to keep it away from the charger to save power.

## Warning

It is important to increase the volume control very gradually to avoid sudden increase sound. Children can't use this product. If you have any problem, please consult otologists.

- 7 -

- 3) When charging, the charging indicator turns red, it will turn green when fully charged. The whole charging process is around 3 hours. Please don't use the product when charging. Please charge it in time to avoid affecting the battery performance and battery life. It's forbidden to let the product connect to AC outlet directly.
- 5) Please pull the plug when any abnormalities occurred during the charging process. (such as odor, fever, deformation)
- 7) The built-in battery capacity is greater than or equal to 60% of rated capacity after 500 cycles of charge and discharge. Please use the required adapter to charge to prevent safety issue, its parameters is

INPUT : 100V ~ 240V, AC 50/60Hz, 0.2A  
OUTPUT : 5V = 1A

as provided in the package.

- 6 -

## Storage

Store in a dry place with good ventilation and related humidity no higher than 80%, and free of corrosive gas.

## Tag Explanation

"ON" — to turn on the power of the amplifier  
 "OFF" — to turn off the power of the amplifier  
 "VOL+" — to turn up the volume  
 "VOL-" — to turn down the volume  
 "MODE" — to switch between high pitch and bass

- All photos are for reference only.

- 8 -